

HRH2048VC

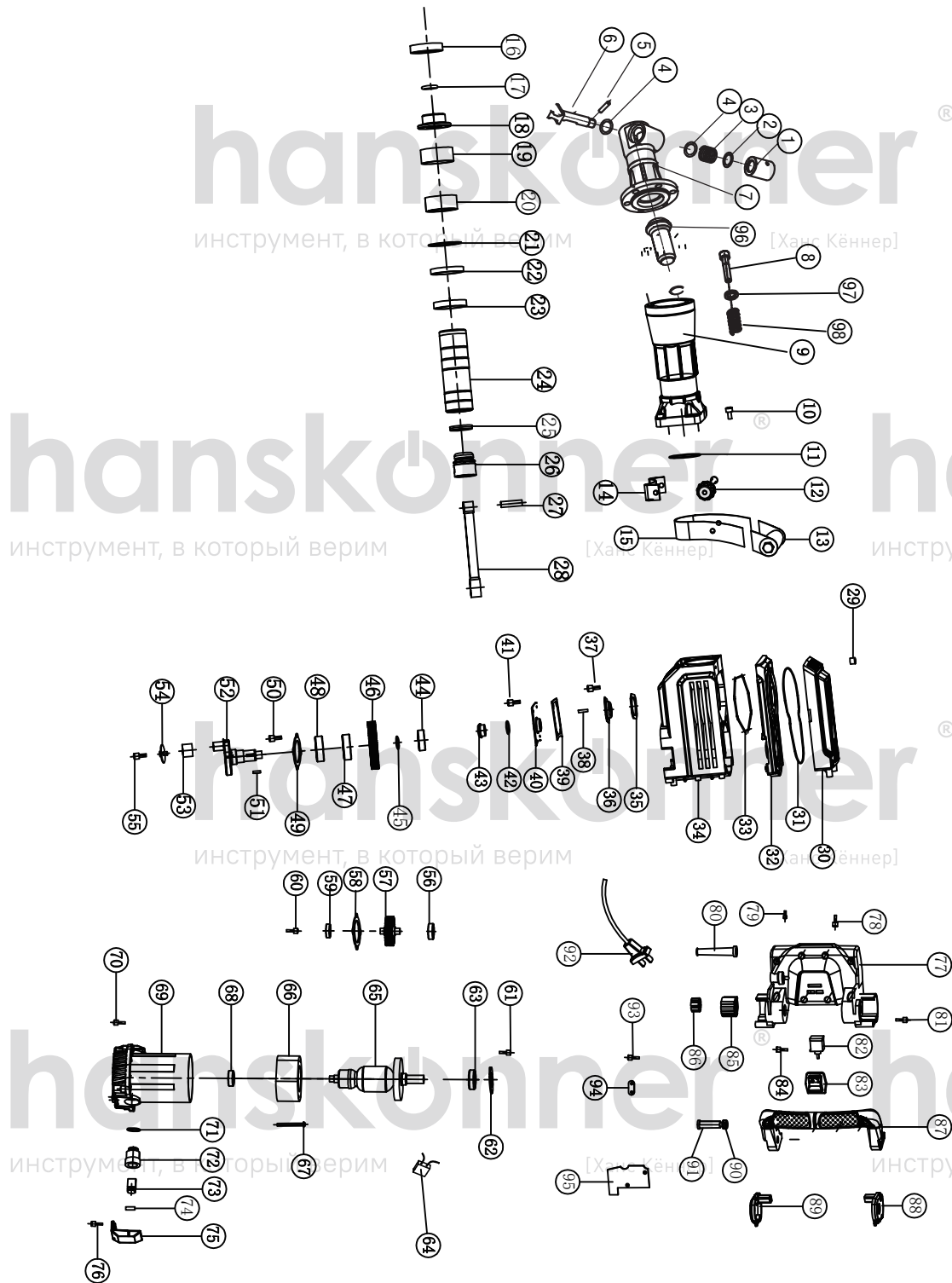

NO.	DESCRIPTION	NO.	DESCRIPTION
1	SLEEVE-NOSE PIECE	50	INNER HEX SCREW M5*16
2	SPRING RELIEF PLATE	51	WOODRUFFE KEY
3	LEVER SPRING	52	ECCENTRIC SHAFT
4	O-RING 18*8	53	NK18/20B NEEDLE BEARING
5	PIN B4*34	54	JOINT LEVER PRESSURE COVER
6	STOP LEVER	55	INNER HEX SCREW M8*25
7	FRONT COVER	56	6201 BEARING
8	INNER HEX SCREW	57	INTERMEDIATE GEAR
9	CYLINDER SLEEVE	58	BEARING REATINING PALTE
10	INNER HEX SCREW M8*40	59	6001 BEARING
11	O SHAPED RING	60	SCREW M6*16
12	ADJUSTING SCREW	61	INNER HEX SCREW M6*18
13	AULIXIARY HANDLE	62	6203 BEARING RETAINING PLATE
14	SUPPORT BRACKET	63	6203 BEARING
15	HOOP	64	CAPACITOR
16	DAMPING RING	65	ARMATURE
17	O SHAPED RING 23.5*5.2	66	STATOR
18	LOCATING SLEEVE	67	SCREW ST5*60
19	SLEEVE-SPLIT RING	68	6201 BEARING
20	SPLIT RING	69	STATOR SEAT
21	IRON WASHER	70	INNER HEX SCREW M8*25
22	DAMPING RING	71	EXTENSION SPRING
23	BIG WASHER $\Phi 68 \times \Phi 58 \times 12$	72	BRUSH HOLDER
24	CYLINDER	73	CARBON BRUSH
25	SEAL RING	74	BRUSH HOLDER CAP
26	ALUMINIUM PISTON	75	BRUSH HOLDER PRESSPLATE
27	PISTON PIN	76	SCREW ST4*18
28	JOINT LEVER	77	HANDLE SEAT
29	INNER HEX SCREW M6*45	78	INNER HEX SCREW
30	GEARCASE COVER	79	INNER HEX SCREW
31	"8" SHAPED RING	80	CORD SLEEVE
32	BAFFLE	81	SCREW ST4*16
33	OIL BAFFLE RING	82	SWITCH
34	GEARCASE	83	SLIDE SWITCH BUTTON
35	OIL BAFFLE WASHER	84	SCREW ST4*14
36	OIL CUP	85	DAMPING SLEEVE
37	INNER HEX SCREW M4*14	86	STEE SLEEVE
38	OIL CORD	87	DAMPING HANDLE
39	SQUARE PAPER WASHER	88	SIDE COVER-RIGHT
40	IRON PLATE	89	SIDE COVER-LEFT
41	INNER HEX SCREW M5*16	90	NUT M10
42	O SHAPED RING	91	SCREW
43	OIL HOLE	92	POWER CORD
44	BEARING 6302	93	SCREW ST4*16
45	EXTERNAL RETAINING RING $\Phi 22$	94	CORD CLAMP
46	BIG GEAR	95	SWITCH PRESSURE COVER
47	STEEL SLEEVE	96	STRIKER LEVER
48	6205 BEARING	97	WASHER
49	6205 BEARING RETAINING PLATE	98	SPRING